

AFFORDABLE RESORT STYLE LIVING FOR ACTIVE ADULTS 55 & OVER.



THE LILAC



ACTUAL PHOTO OF HOME NOT AVAILABLE

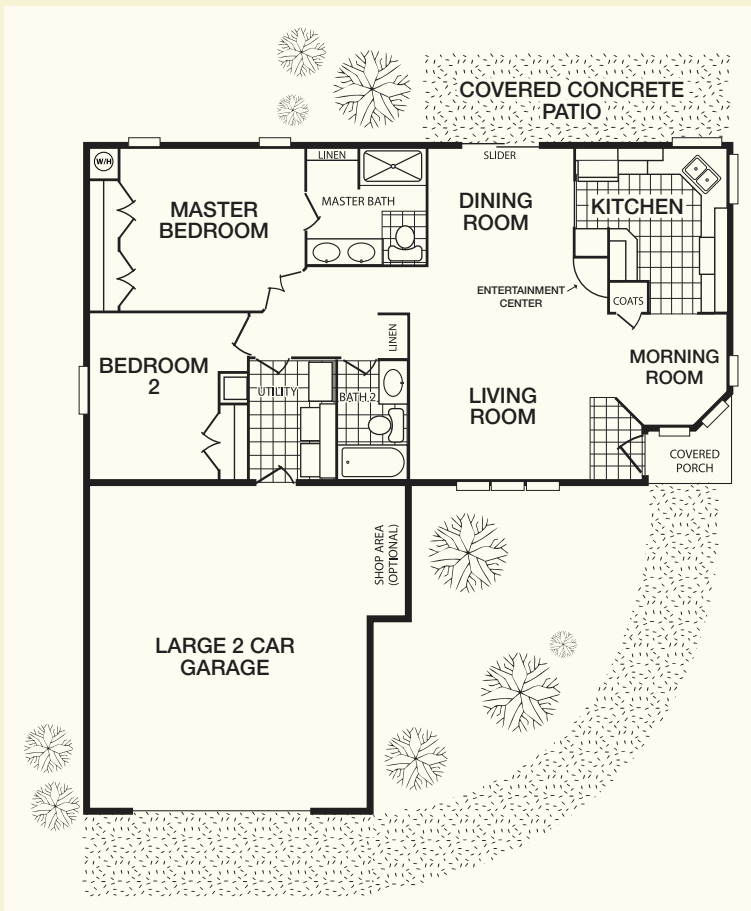

The Lilac is a bright cheerful, two bedroom, two bath home whose kitchen is convenient to the dining, living & morning room areas creating an excellent space for relaxing or entertaining. The Lilac comes with a finished large two car garage (extended garage available when lot size allows), heat pump, back or side yard wood covered patio, street post light and rear yard vinyl fencing.

**1300 SQ. FT. (APPROX.)
2 BEDROOM, 2 BATH
w/COVERED FRONT ENTRY**

Floor plan shown for display purpose only. Subject to change without notice.
Landscaping and lot configuration may differ.

Homes built by
Marlette

200 Bridle Way #200 | Yakima, WA 98901
1 (509) 469-2926 • 1 (877) 469-2992

LAKESHORE
HOME SALES, LLC

